

BENDIX GEAR SEAL INSTALLATION TIPS

See image on page 2 for part numbers referenced.

1. Make sure the packing nut will turn BEFORE you jack the plane.
2. Jack and remove wheel and brake assembly and lower scissor bolt.
3. Tie it all out of the way
4. Remove upper service plug to avoid air lock, but if you have to slide hammer the lower unit, be careful it doesn't blow fluid out of the service hole.
5. When you remove the lower unit, the big spring #1 and a big washer #2 will come out. Sometimes the washer will get stuck and drop out later: ACCOUNT FOR THIS WASHER.
6. Warm up solder on the upper bearing #3 and use a pick to push out the four pins #4 from the back side. You will reuse the pins. Hopefully no one used silver solder.
7. If you have wear on the metering pin #5 (see wear example image below, but do not remove pin), it probably means the packing nut #6 and the top bearing #3 are worn out or were worn out in the past.
Packing nut max I.D. 2.697
Top Bearing max O.D. 2.922
8. Assemble as per photo. Make sure the packing nut is clean. Install seal #7 AR1102 with lip up (goes in the hard way). Put pins back in top bearing and sweat solder in pins. Use solder only. NO silver solder. Note the second, thicker blue ring #8 AR1103 takes up the space from the original packing rings. Instructions say glue them together. Discard them and use the thicker blue ring. This thick ring, AR1103 does not show up in the installation instructions.
9. Use STP oil additive on seal and inside gear leg.
10. Don't forget washer and spring.
11. Stuff ALL the parts ALL the way up in the leg. The seal will be difficult to get all the way in. DO NOT USE the packing nut to push them in. When they are all fully pushed up in the hole then the nut should easily screw in and show about 2-3 threads. It is NOT a packing nut any longer, just a retaining nut. The nut will bottom out against the small blue ring #9, which bottoms out in the gear leg to set the seal cavity dimension. You will have to use paint sticks or dull screwdriver to *carefully* work the seal all the way up and in.

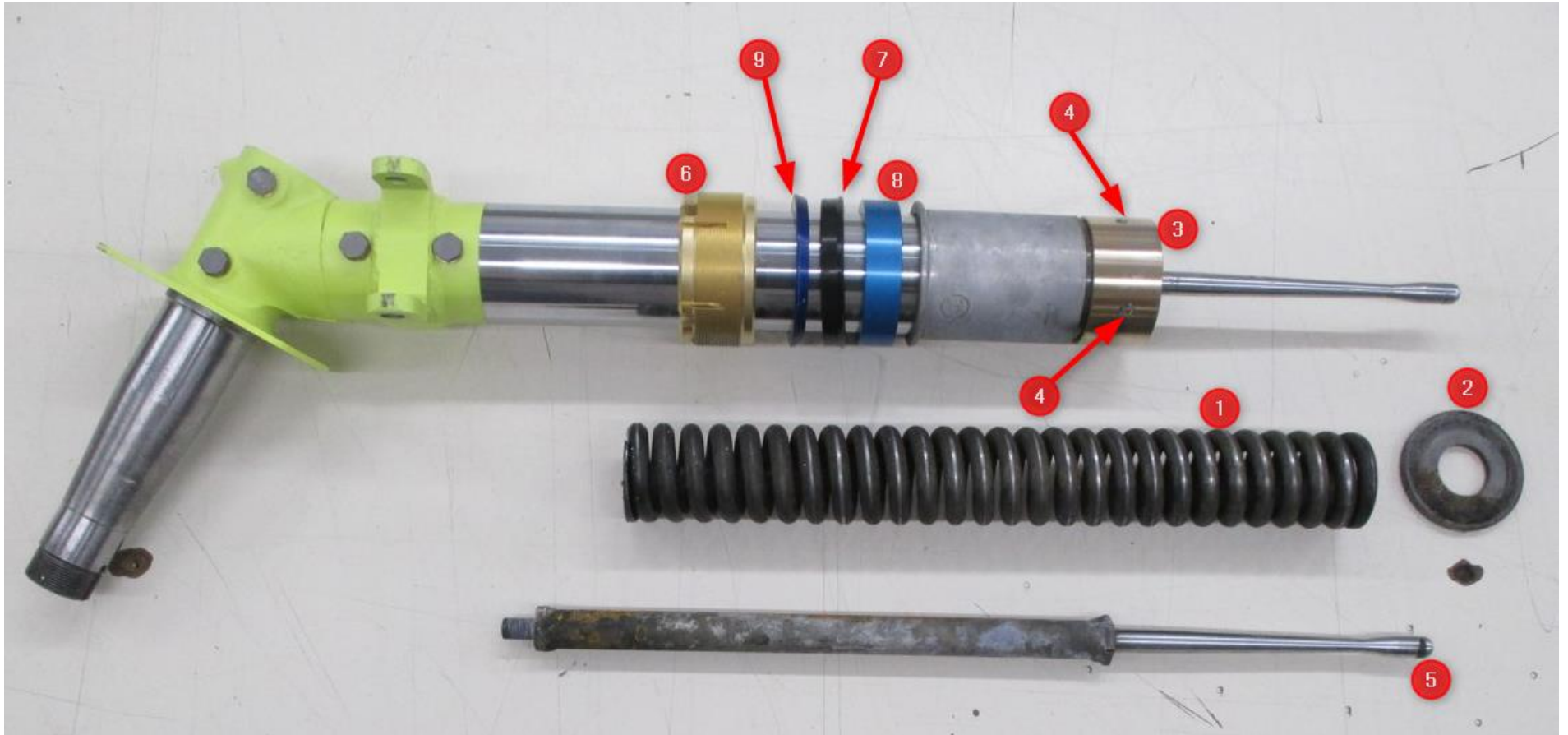

1. Big Spring
2. Big Washer
3. Top Bearing
4. Four Pins on Top Bearing
5. Metering Pin (example: removed pin shows wear on end - DO NOT REMOVE PIN)
6. Packing Nut
7. Black Seal - AR1102
8. Thick Blue Ring - AR1103
9. Small Blue Ring - AR1101